



MAIN INFORMATION		Canister
Code		385.000

RAW MATERIAL		CLOSURE SYSTEM	
PP - Polypropylene	X	Snap + Tamper evidence	X
PS - Polystyrene		Membrane seal	
PE - Polyethylene		Easy open Aluminum	
Food Approvals			

DIMENSION		LID SUITABLE (Code)
Weight (g)	28,9	386.000
Brimful volume (ml)	1640	
Useful volume (ml)	1640	

DECORATION	
Adhesive label	Offset
I.M.L	Skinny
I.M.S.	Other
I.M.S. barrier	

PACKING	Box	Box	Palbox	
	400 x 400	400 x 600	800 x 1200	
	h 500	h 500	h 700	h 900
N° x box			864	
Weight box (Kg)			25	
Boxes x pallet			3	
Weight pallet (Kg)			75	
N° x pallet			2592	

IMAGE



EXTERNAL DIMENSIONS (mm)

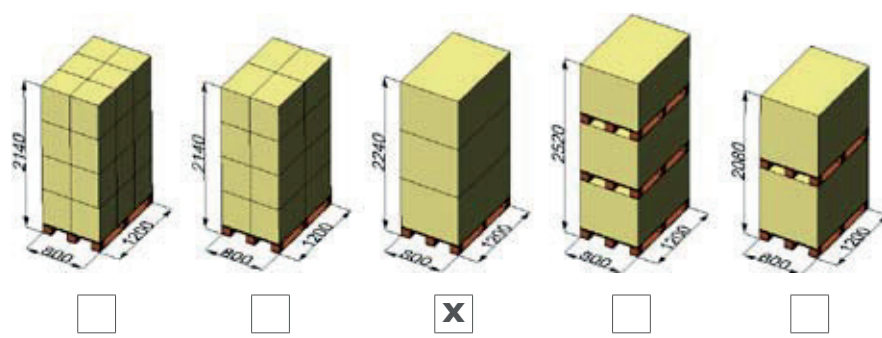
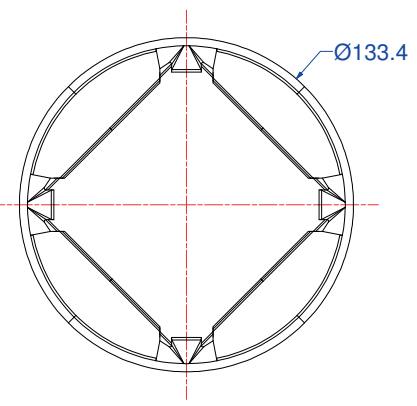
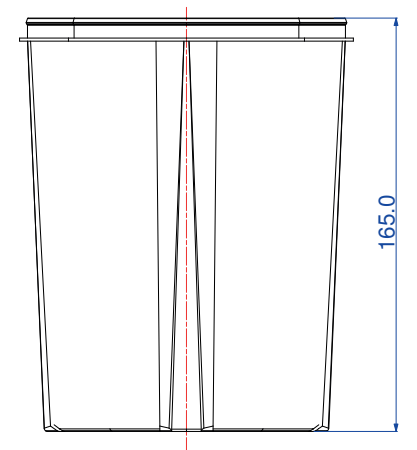

MAIN INFORMATION		Canister lid	
Code		386.000	
RAW MATERIAL		CLOSURE SYSTEM	
PP - Polypropylene	X	Snap + Tamper evidence	X
PS - Polystyrene		Membrane seal	
PE - Polyethylene		Easy open Aluminum	
DIMENSION		SUITABLE FOR (Code)	
Weight (g)	11,9	385.000	
DECORATION		FOOD APPROVALS	
Skinny	X		
PACKING		Box	Palbox
		400 x 400	800 x 1200
		h 500	h 700 h 900
N° x box			5421
Weight box (Kg)			65,5
Boxes x pallet			3
Weight pallet (Kg)			200
N° x pallet			16263

EXTERNAL DIMENSIONS (mm)

Technical drawing showing external dimensions (mm) of the canister lid. The drawing includes a side view and a top view. The side view shows a height of 8.5 mm. The top view shows a diameter of 200.8 mm and a central hole diameter of 132.8 mm. A small detail shows a diameter of 50.0 mm.

Five 3D isometric views of the canister lid on a pallet. The first four views are marked with a square box, and the fifth view is marked with a square box containing an 'X', indicating it is the selected configuration.